

RAJPURA



Legend **नियंत्रित क्षेत्रों की सीमाओं को दर्शाया गया है**

schedule of plots

S.No	category	no. of plots	size	Area in sq. yds.
1	plots	14	30x60	2800 "
2	plots	8	32x60	1704 "
3	"	8	20x45	800 "
4	"	4	15x15	635 "
		34		

Total area of the scheme = 9302 SQ. YDS (App)
 Area under plots = 5937 "
 Area under Roads & park = 3365 "

Layout plan of pocket near Shamshan bhoomi, Anand nagar, Rajpura.

Note: This org supercedes previous org. no. 2603/95 dt. 5.8.95

Scale: 1" = 20'-0"



dept. of town & country planning pb drawing no. dt P/P/2643/96 dated 20-2-96

drawn by: [Signature]
 checked by: [Signature]
 planning officer

Asst. town planner patiala [Signature]
 town planner patiala [Signature]
 chief town planner pb Chandigarh [Signature]

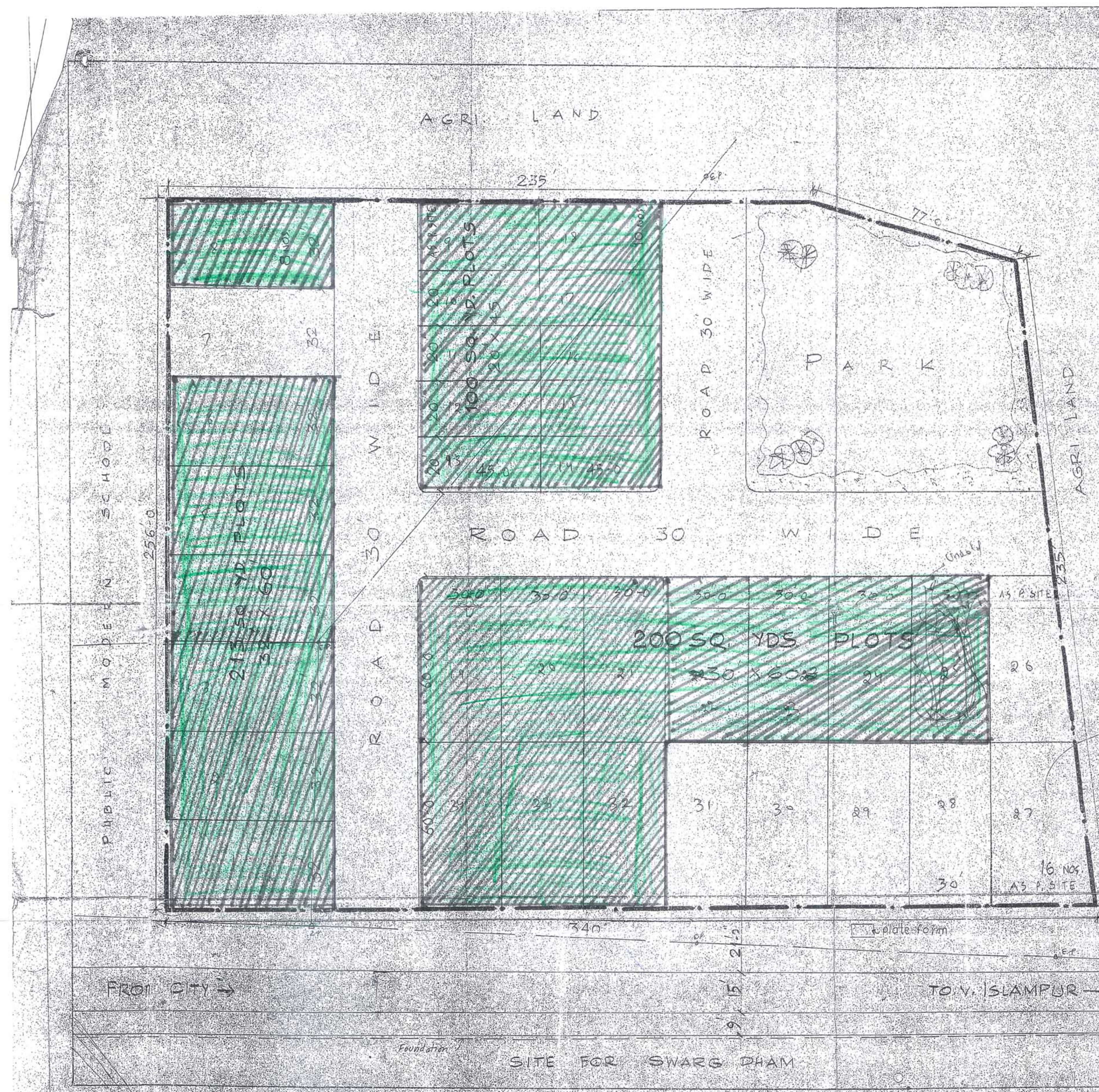

FROM CITY →

→ TO V. ISLAMPUR

SITE FOR SWARG DHAM